

Asking Price £170,000

Jayman
www.jayman.co.uk

Estate Agents



Sandpiper Close

Cannock, Staffordshire, WS12 4RN

Sandpiper Close, Cannock, Staffordshire WS12 4RN

Jayman offer for sale this well presented two bedroom terrace house on Sandpiper Close.

With spacious living room, Kitchen / Diner, two good sized bedrooms, bathroom and rear garden.

Jayman offer for sale this two bedroom mid terraced house, situated in Sandpiper Close in Hednesford.

The accommodation comprises of, lounge, kitchen, two bedrooms, fitted bathroom and off road parking.

The property itself is situated within close proximity to all local schools, a wide variety of amenities, commuter services and transport links.

The property also benefits from being a short distance from the beautiful and ever popular Cannock Chase forest.

Hallway leading to:

Lounge 13'5" x 10'5" (4.1 x 3.2)

Spacious lounge with window to fore, door leading to the Kitchen / Diner to rear and with stairs leading to the first floor.

Kitchen 13'5" x 8'2" (4.1 x 2.5)

With a range of storage cupboards, sink and drainer, window and door to rear garden.

Doors leading into the garden.

Bedroom 1 13'5" x 10'5" (4.1 x 3.2)

Double bedroom to the front of the property.

Bedroom 2 11'1" x 6'10" (3.4 x 2.1)

Good sized second bedroom.

Bathroom

Suite compromising of shower over bath, w/c, hand basin and heated towel rail.

To Rear

Easily maintained rear garden.



REQUIRE A MORTGAGE? Our independent advisor can compare "whole of market" to help find the best mortgage to suit your circumstances. Please call 01543 416 567 for a free mortgage quote including some deals only available through our network. **LEGAL CONVEYANCING** Jayman Conveyancing provides fast efficient low cost legal work with a no sale-no fee guarantee. Call 01543 416 567. **AGENTS DESCRIPTIONS** These details imply the opinion of the agent at the time these details were prepared and are subjective. It may be that the purchaser's opinion differs. **VIEWING ARRANGEMENTS** By appointment only with Jayman on 01543 416 567 **COUNCIL TAX** Please refer to www.voa.gov.uk for this information. **DESCRIPTIONS AND MEASUREMENTS** All measurements are approximate and some may be maximum on irregular walls. The plan shows the approximate layout of the rooms to show the inter relationship of relationship of one room to another but is not necessarily to scale. **CONSENTS** We have not had sight of any relevant building regulations, guarantees or planning consents and all relevant documentation pertaining to this property should be checked by your legal advisor before exchanging contracts.

GROUND FLOOR

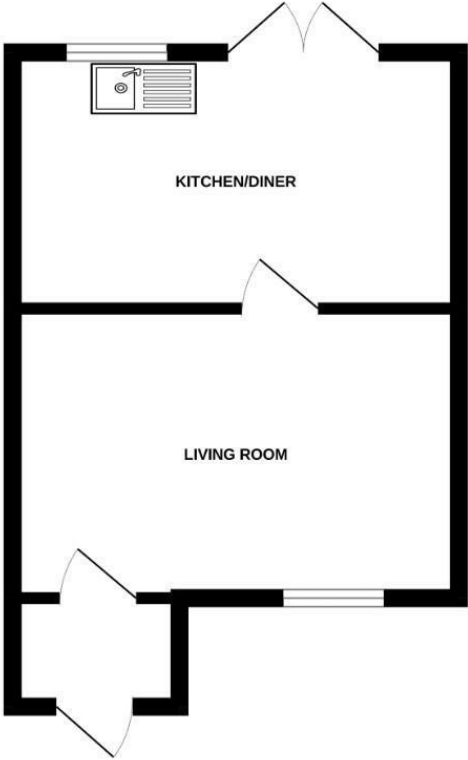

1ST FLOOR

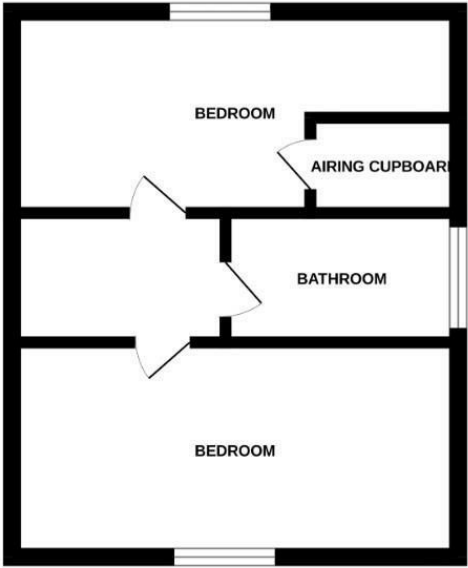

Whilst every attempt has been made to ensure the accuracy of the floorplan contained here, measurements of doors, windows, rooms and any other items are approximate and no responsibility is taken for any error, omission or mis-statement. This plan is for illustrative purposes only and should be used as such by any prospective purchaser. The services, systems and appliances shown have not been tested and no guarantee as to their operability or efficiency can be given.
Made with Metropix ©2025

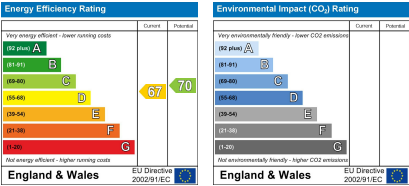
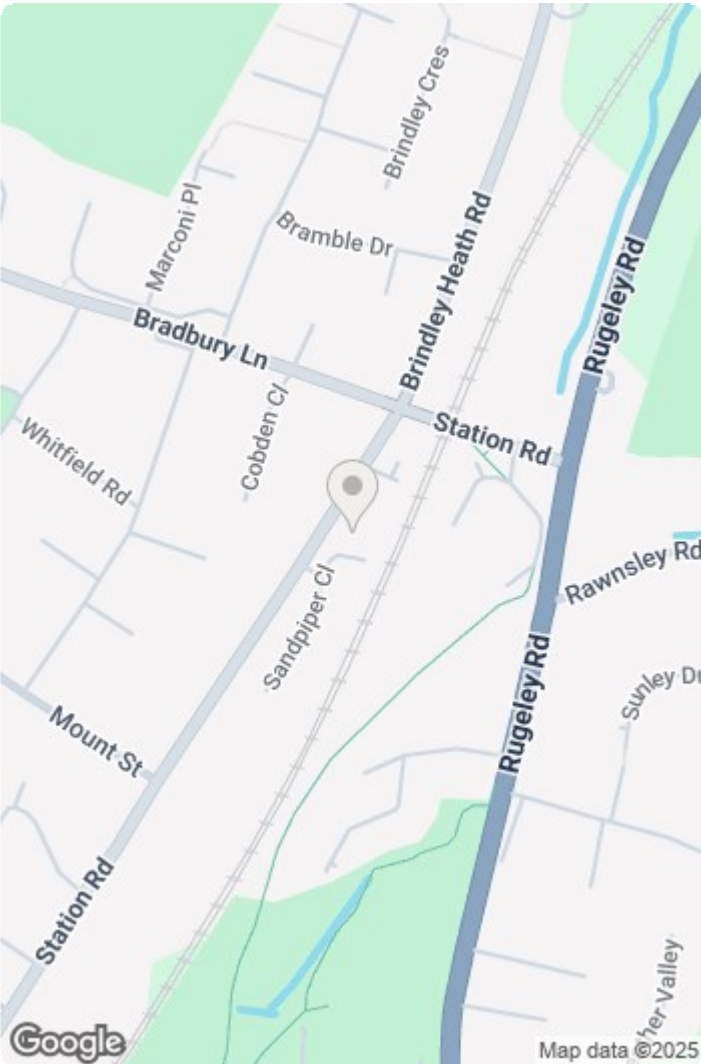

We endeavour to make our sales details accurate and reliable but they should not be relied on as statements or representations of fact and they do not constitute any part of an offer or contract. The seller does not make any representation or give any warranty in relation to the property and we have no authority to do so on behalf of the seller. Services, fittings and equipment referred to in the sales details have not been tested (unless otherwise stated) and no warranty can be given as to their condition. We would strongly recommend that all information, which we provide, about the property is verified by yourself or your advisers.

